

# VM Lock



## psit PAREDE SIMPLES SINGLE WALL LISA INOX STAINLESS STEEL FLAT

Parede Simples Lisa Inox com braçadeira e O-ring de Silicone alta temperatura (250°)

Single-wall Flat Stainless Steel with bracket and silicone O-ring high temperature (250°)

Aplicações: caldeiras a gás, condensação e estanques, pellets, ventilação, etc.

Applications: gas boilers, condensing and sealed units, pellets and ventilation.

Combustível: Pellets, briquetes, gás, gasóleo, carvão.

Fuel: pellets, gas, diesel, coal.

Fabricado em aço inoxidável AISI 304 CrNi 18/10 de 1ª qualidade, polido, com espessura 0,5mm. Opcional em inox 316.

Made of stainless steel AISI-304 CrNi 18/10, 1st quality, polished, with a thickness of 0.5 mm. Optional in st. st. 316.

Características: Cada módulo possui uma braçadeira de aperto e O-ring de silicone que suporta até 250° em contínuo. Tem sentido de montagem obrigatório, identificado na etiqueta.

Features: Each module has a collar unit and silicone O-ring that holds up to 250 ° continuously. Direction of assembly required, identified on the label.

Pode ser fornecido pintado de Preto ou Antracite - 900°.

Can be supplied painted in Black or Anthracite - 900 °.





Tubo 1m  
1m Pipe



Curva 45°  
45° Elbow



Curva 90°  
90° Elbow



Chapéu Simples com Cone Interior  
Rain Cap with Interior Cap



Chapéu com Aba com Cone Interior  
Anti Down-draught Terminal with Interior Cone



Chapéu Saturno  
Saturn Cap



Tê 45° com Tampo  
45° Tee with End Cap



Tê 90° com Tampo  
90° Tee with End Cap



União 14cm Fêmea/Fêmea  
14cm Union Female/Female



União 14cm Macho/Macho  
14cm Union Male/Male



Braçadeira de União  
Bracket



O-ring de Silicone  
Silicone O-ring

▶▶▶ 101.001. Ø ▶▶▶ 101.002. Ø ▶▶▶ 101.003. Ø

Tubo 1m 1m Pipe Tubo 50cm 50cm Pipe Tubo 33cm 33cm Pipe

Ø	A	B	un/emb	Ø	A	B	un/emb	Ø	A	B	un/emb
080	1000	955	6	080	500	455	6	080	333	288	6
100	1000	955	6	100	500	455	6	100	333	288	6
120	1000	955	6	120	500	455	6	120	333	288	6
125	1000	955	6	125	500	455	6	125	333	288	6
140	1000	955	6	140	500	455	6	140	333	288	6
150	1000	955	6	150	500	455	6	150	333	288	6
175	1000	955	6	175	500	455	6	175	333	288	6
180	1000	955	6	180	500	455	6	180	333	288	6
200	1000	955	6	200	500	455	6	200	333	288	3
230	1000	955	4	230	500	455	2	230	333	288	3
250	1000	955	4	250	500	455	2	250	333	288	3
300	1000	955	4	300	500	455	1	300	333	288	1
350	1000	955	1	350	500	455	1	350	333	288	1
400	1000	955	1	400	500	455	1	400	333	288	1
450	1000	955	1	450	500	455	1	450	333	288	1
500	1000	955	1	500	500	455	1	500	333	288	1
...											

Pormenor de Encaixe  
Assembly Detail

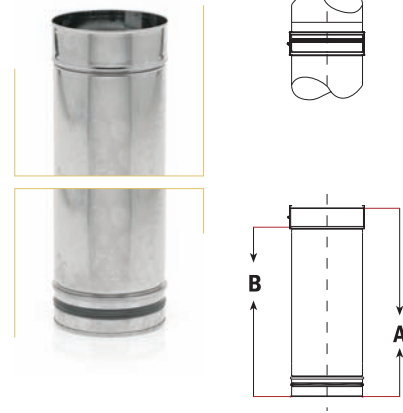

▶▶▶ 101.009. Ø ▶▶▶ Curva 45° 45° Elbow

Ø	A	B	C	un/emb
080	75	140	140	6
100	95	145	145	6
120	95	150	150	6
125	95	155	160	6
140	105	155	160	6
150	110	150	165	6
175	135	180	215	6
180	135	180	215	6
200	140	185	220	6
230	165	210	250	2
250	165	215	265	2
300	185	220	275	1
350	225	240	350	1
400	268	335	440	1
450	285	335	455	1
500	320	375	515	1

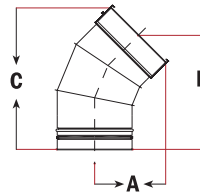

▶▶▶ 101.010. Ø ▶▶▶ Curva 90° 90° Elbow

Ø	A	B	C	un/emb
080	155	100	150	6
100	175	120	170	6
120	180	120	180	6
125	185	120	180	6
140	170	120	200	6
150	180	120	195	6
175	260	210	275	6
180	265	215	280	6
200	275	215	290	6
230	275	215	320	1
250	275	220	345	1
300	260	205	355	1
350	325	270	445	1
400	400	335	535	1
450	450	420	640	1
500	500	470	670	1

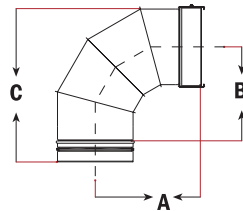

▶▶▶ 101.012. Ø ▶▶▶ Chapéu Simples com Cone Interior Rain Cap with Interior Cap

Ø	A	B	C	un/emb
080	200	195		4
100	200	215		4
120	200	235		4
125	200	240		4
140	200	255		4
150	200	265		4
175	200	190		1
180	200	295		1
200	200	315		1
230	200	345		1
250	200	365		1
300	200	415		1
350	200	465		1
400	200	515		1
450	200	565		1
500	200	615		1

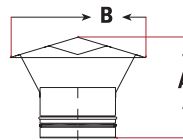

▶ 101.013. Ø ◀ Chapéu com Aba com Cone Interior Anti Down-draught Terminal with Interior Cone

Ø	A	B	C	un/emb
080	200	250	125	1
100	200	270	125	1
120	200	290	125	1
125	200	295	125	1
140	200	310	125	1
150	200	320	125	1
175	200	345	125	1
180	200	350	125	1
200	200	370	125	1
230	200	400	125	1
250	200	420	125	1
300	200	470	125	1
350	200	520	125	1
400	200	570	125	1
450	200	620	125	1
500	200	670	125	1

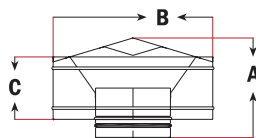

▶ 101.089. Ø ◀ Chapéu Saturno Saturn Cap

Ø	A	B	C	un/emb
080	230	145		1
100	235	165		1
120	240	190		1
125	240	190		1
140	240	215		1
150	240	215		1
175	240	240		1
180	240	245		1
200	245	265		1
230	250	295		1
250	250	315		1
300	250	365		1
350	250	415		1
400	275	465		1
450	275	515		1
500	275	565		1

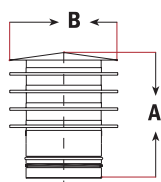

▶ 101.007. Ø ◀ Tê 45° com Tampo 45° Tee with End Cap

Ø	A	B	C	un/emb
080	250	235	130	4
100	260	245	140	4
120	305	275	165	4
125	310	280	165	4
140	335	300	185	4
150	355	315	190	4
175	390	345	220	4
180	390	345	220	4
200	425	365	235	2
230	500	395	350	1
250	520	435	285	1
300	625	490	430	1
350	695	540	490	1
400	815	640	570	1
450	890	690	630	1
500	1010	790	710	1

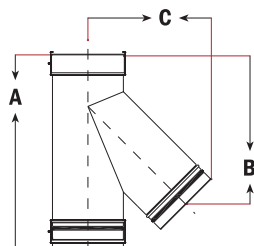

▶ 101.006. Ø ◀ Tê 90° com Tampo 90° Tee with End Cap

Ø	A	B	C	un/emb
080	200	120	120	4
100	215	130	130	4
120	240	140	140	6
125	245	143	143	6
140	260	150	150	6
150	270	155	155	6
175	290	170	165	4
180	295	170	170	4
200	330	185	185	2
230	390	185	295	2
250	385	215	215	2
300	455	250	250	1
350	505	275	275	1
400	555	300	300	1
450	580	325	350	1
500	630	335	335	1

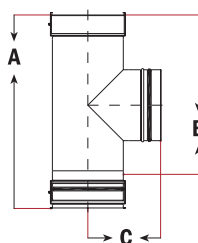

▶▶ 101.011F. Ø ◀◀ União 14cm Fêmea/Fêmea 14cm Union Female/Female

Ø	A	B	C	un/emb
080	140			10
100	140			10
120	140			8
125	140			8
140	140			8
150	140			8
175	140			4
180	140			4
200	140			2
230	140			2
250	140			2
300	140			2
350	140			2
400	140			2

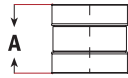

▶▶ 101.011M. Ø ◀◀ União 14cm Macho/Macho 14cm Union Male/Male

Ø	A	B	C	un/emb
080	140			10
100	140			10
120	140			8
125	140			8
140	140			8
150	140			8
175	140			4
180	140			4
200	140			2
230	140			2
250	140			2
300	140			2
350	140			2
400	140			2



▶▶ 101.BR. Ø ◀◀ Braçadeira de União Bracket

Ø	A	B	C	un/emb
080	42			10
100	42			10
120	42			10
125	42			10
140	42			10
150	42			10
175	42			10
180	42			10
200	42			10
230	42			10
250	42			10
300	42			10
350	42			10
400	42			10



▶▶ 101.JSP. Ø ◀◀ O-ring de Silicone Silicone O-ring

Ø	A	B	C	un/emb
080				10
100				10
120				10
125				10
140				10
150				10
175				10
180				10
200				10
230				10
250				10
300				10
350				10
400				10

